

## Cordless string trimmer

Manual

**40 V** **13"**

Cutting diameter

Applies for:

Codes	Items
103243	DESI-40A
103554	DESI-40AS

# DESI-40A





**CAUTION**



Read this manual thoroughly  
before using the tool.



Technical data .....	3
Power requirements .....	3
 General safety warnings for electric tools .....	4
 Safety warnings for the use of string trimmers .....	5
General warnings for the battery .....	7
General warnings for the battery charger .....	7
Parts .....	8
Assembly .....	9
Start up .....	10
Maintenance .....	12
Accessories and replacements .....	12
Troubleshooting .....	12
Authorized service centers .....	13
Warranty policy .....	14

### CAUTION

To get the most out of the tool, extend its lifespan, claim the warranty if necessary, and avoid serious risks or injuries, please read this manual thoroughly before using the tool.

Please keep this manual for future references

The illustrations in this manual are for reference only and may differ from the real appearance of the tool.

## Usage and care recommendations

 Use **ONLY** the provided charger or the one suggested by **TRUPER** to charge the battery.

 Follow the battery **GUIDELINES** and charging **INSTRUCTIONS** (page 5).

 Always USE the **SAFETY GUARD** and nylon line with a **DIAMETER** of 0.080"

 To cut tall grass, do it gradually. **DO NOT** try to cut it all at once from the base (page 11).

 **KEEP** the tool and charger ventilation slots **CLEAN**.

 Perform regular **MAINTENANCE** on your machine (page 12).

DESI-40A		DESI-40AS
Code	103243	103554
Description	Cordless string trimmer	
Cutting diameter	13"	
Voltage	40 V ---	
Speed	7 500 RPM	
Weight with batteries	6.1 lb	
Trimmer line diameter	0.080"	
Battery	2 Ah 20V--- Li-Ion battery Charging time: 75 min approx.	NOT INCLUDED
Charger	Inlet: Voltage: 127 V~ Frequency: 60 Hz Power: 100 W Outlet: 14.4 V--- - 20 V--- Current: 4 A	NOT INCLUDED
IP grade	IP20	

The power cable has cable clamps of the type: Y.  
The construction class of the tool is: Class III.  
The construction class of the charger is: Reinforced insulation.

**⚠ WARNING** If the power cable is damaged, it must be replaced by the manufacturer or a TRUPER Service Center to prevent any risk of electric shock or significant accident.

The electrical insulation of this tool is compromised by splashes or spillage of liquids during its operation. Do not expose it to rain, liquids, and/or moisture.



**⚠ WARNING** Before accessing the terminals, all power circuits must be disconnected.

## Power requirements

**⚠ WARNING** Double-insulated and reinforced insulation tools are equipped with a polarized plug (one prong is wider than the other). This plug fits into any polarized outlet and can only be inserted one way. If the plug does not fit into the outlet, turn it over. If it still does not fit, contact a qualified electrician, or install a polarized outlet. Do not alter the plug in any way. Both types of insulation eliminate the need for a three-prong grounded power cord or a grounded electrical system.

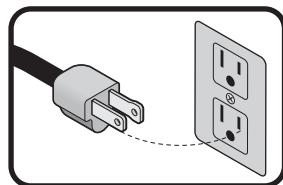

### ⚠ WARNING

When using an extension cord, ensure that it is of sufficient gauge to carry the current your tool will consume. A lower gauge cord will result in voltage drops in the line, leading to power loss and motor overheating. The following table shows the correct size to use depending on the cable length and amperage capacity indicated on the tool's data plate. If in doubt, use the next higher gauge.

Capacity in Amperes	Number of conductors	Extension gauge	
		From 6 ft to 49 ft	Higher than 49 ft
from 0 A to 10 A	3 (one to ground)	18 AWG(*)	16 AWG
from 10 A to 13 A		16 AWG	14 AWG
from 13 A to 15 A		14 AWG	12 AWG
from 15 A to 20 A		8 AWG	6 AWG

\* It is allowed to use it if the extensions themselves have an overcurrent protection device.

AWG = American Wire Gauge. Reference: NMX-J-195-ANCE.

**⚠ WARNING** When operating electric tools outdoors, use a grounded extension cord marked as **6VOLTECK** 'Outdoor Use'. These extensions are specially designed for outdoor use and reduce the risk of electric shock.





**WARNING!** Read all safety warnings and all instructions listed below carefully. Failure to follow any of them may result in electric shock, fire, and/or serious injury. **Keep the warnings and instructions for future reference.**

### Work area

**Keep your work area clean, organized, and well-lit.**

Cluttered and dim areas can lead to accidents.



**Do not operate the tool in explosive atmospheres, such as in the presence of flammable liquids, gas, or dust.**

The electric tools produce sparks that can ignite flammable material.



**Keep children and other individuals at a safe distance while using the equipment.**

Distractions can cause loss of control and lead to accidents.



### Electrical Safety

**Electrical tool plugs must match the outlet. Never modify the plug in any way.**

**Do not use adapters with grounded electrical tools.**

Unmodified electrical tools and matching plugs will reduce the risk of electric shock.



**Avoid bodily contact with grounded surfaces, such as pipes, radiators, stoves, and refrigerators.**

There is an increased risk of electric shock if your body is grounded.

**Do not expose the tool to rain or humid conditions.**

The entry of water into an electrical tool will increase the risk of electric shock.

**Do not force the cable. Never use the cable for carrying, lifting, or disconnecting the tool. Keep the cable away from heat, oil, sharp edges, or moving parts.**

Damaged or tangled cables increase the risk of electric shock.

**When operating an electrical tool outdoors, use an extension cord suitable for outdoor use.**

The use of a suitable outdoor-rated cable reduces the risk of electric shock.

**If it is unavoidable to operate an electrical tool in a damp location, use a power source protected by a Residual Current Device (RCD).**

The use of a Residual Current Device (RCD) reduces the risk of electric shock.

### Personal Safety

**Be alert, watch what you are doing, and use common sense when handling a tool. Do not use it if you are tired or under the influence of drugs, alcohol, or medication.**

A moment of distraction while using the tool can cause personal injury.

**Use safety equipment. Always wear eye protection.**

The use of safety equipment such as safety glasses, dust mask, slip-resistant shoes, helmet, and ear protection in appropriate conditions significantly reduces the risk of personal injury.



**Avoid accidental starts. Ensure the switch is in the "off" position before connecting to the power source and/or the battery or transporting the tool.**

Carrying power tools with your finger on the switch or connecting power tools with the switch in the "on" position can cause accidents.

**Remove any wrenches or adjusting tools before starting the power tool.**

Wrenches or tools left on the rotating parts of the tool can cause personal injury.

**Do not exceed your range of motion. Keep both feet firmly planted on the ground and always maintain balance.**

This allows better control of the tool in unexpected situations.

**Dress appropriately. Do not wear loose clothing or jewelry. Keep your hair, clothing, and gloves away from moving parts.**

Loose clothes, jewelry, or long hair can get caught in moving parts.



**If dust extraction and collection devices are available for the tool, check their connections and use them correctly.**

The use of these devices reduces risks associated with dust.

### Tool use and care

**Do not force the tool. Use the appropriate tool for the task at hand.**

The right tool performs better and is safer when used at the intended pace.



**Do not use the tool if the switch is not functioning.**

Any power tool that cannot be turned on or off is dangerous and must be repaired before operation.

**Disconnect the tool from the power source and/or battery before making any adjustments, changing accessories, or storing it.**

These measures reduce the risk of accidentally starting the tool.

**Store the tools out of the reach of children and do not allow them to be handled by individuals unfamiliar with the tools or their instructions.**

Power tools are dangerous in untrained hands.



**Maintain the tool. Ensure that the moving parts are not misaligned or jammed, and that there are no broken parts or other conditions that may affect its operation. Repair any damage before using the tool.**

Many accidents are caused by inadequate tool maintenance.



**Keep cutting accessories sharp and clean.**

Well-maintained cutting accessories are less likely to jam and easier to control.

**Use the tool, its components, and accessories in accordance with these instructions and as intended for the type of tool, in appropriate working conditions.**

Using the tool for applications other than those for which it is designed could cause a hazardous situation.

### Use and care of battery-powered tool

**Recharge only with the charger specified by TRUPER.**

Using a different charger may cause a fire hazard.

**Use batteries specifically designed for the tool.**

Using any other battery may pose a risk of damage and fire.

## General safety warnings for electric tools



# TRUPER PRO

Ensure the switch is in the off position before inserting the battery.

Inserting the battery into electric tools with the switch on can cause issues.

When the battery is not in use, keep it away from other metal objects such as clips, coins, keys, nails, screws, or other small metal objects that can create a connection from one terminal to another.

Short-circuiting the terminals together can cause burns or a fire.

Under abusive conditions, battery liquid may be expelled; avoid contact. If accidental contact occurs, rinse with water.

If the liquid meets eyes, seek medical attention. The liquid expelled from the battery can cause irritation or burns.

### Service

Send your electric tool for repair to trained personnel using only identical replacement parts.

This will ensure the safety of the electric tool is maintained.

## Safety warnings



for the use of string trimmers



Safety is a combination of common sense, alertness, and understanding how the tool operates.

**CAUTION** • Read the instructions carefully before using the tool. Pay attention to safety rules, warning symbols, and notices of danger, caution, and attention in the instructions and on the labels attached to the tool.

- This device is not intended for use by individuals (including children) whose physical, sensory, or mental abilities are different or impaired, or who lack experience or knowledge, unless they receive supervision or training in the operation of the device by a person responsible for their safety.
- Children should be supervised to ensure that they do not use the devices as toys.

## Batteries and charger

**DANGER** • Use only TRUPER chargers to charge the tool's battery. Using another charger can cause a fire or injury.

- Connect the charger only to an alternating current (AC) power supply.

**DANGER** • Do not use the charger outdoors.

- Respect the polarity "+" / "-" when charging.
- Never recharge a leaking battery.
- Do not use batteries or the charger for purposes other than those for which they were designed.
- Do not modify the battery or charger contacts.
- Never expose batteries to temperatures exceeding 122 °F.

**DANGER** • Never expose batteries to fire; they could explode.

**CAUTION** • The battery can be damaged by sharp objects such as nails or screwdrivers or if subjected to external force.

**CAUTION** • Do not open the battery; there is a risk of short circuit. Protect the battery from heat, intense continuous sunlight, fires, water, and moisture.

**DANGER** • Risk of explosion. In case of damage and incorrect use of the battery, it may emit vapors. Ventilate the area and consult a doctor if you feel unwell. Vapors can irritate the respiratory system.

**CAUTION** • To maximize battery life, discharge it completely at least once a month. Do not leave the battery uncharged for more than three months. Always charge the battery to its maximum capacity. Before using the machine for the first time, charge the batteries for a minimum of 75 minutes.

- Avoid constantly stopping while operating the tool to prevent damage to the battery.

• Do not throw batteries into the fire. The cell can explode. Check local codes for possible special disposal instructions.

**CAUTION** Remove the batteries before performing any work on the power tool. Batteries must be charged before first use.

- Ensure the exterior of the batteries is clean and dry before connecting them to the charger or machine.
- Insert the batteries into the machine's base and push them until they click into place (2).
- To remove them, press the battery release button (1).

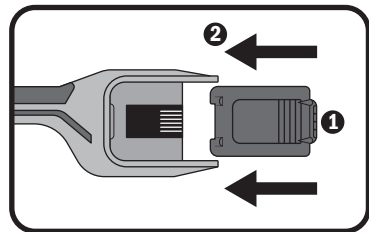



**⚠ WARNING** • Remember that this tool is designed for cutting grass as indicated in this manual. Under no circumstances should it be used for any other purpose.

### Before operating the tool

**⚠ CAUTION** • Read the instructions carefully. Familiarize yourself with the controls and proper use of the equipment.

- Use eye protection.
- Never allow children or unfamiliar individuals to use the device.
- Avoid using the device while people are around, especially children or pets.
- Use the device only in daylight or when there is good lighting.
- Never operate the device with a damaged guard or without guards and protections in place.
- Start the engine only when hands and feet are away from the cutting elements.
- Never assemble metal cutting elements.
- Use only manufacturer-recommended replacement parts and accessories.
- Always disconnect the charger when not in use.
- Remove batteries before maintenance or cleaning.

Inspect and regularly maintain the device. The equipment should only be repaired at an authorized service center.

- Be careful not to injure yourself with the blades used to adjust the filament length. After installing a new cutting filament, return the device to its normal operating position before turning it on again.
- Always ensure that the ventilation holes are free from debris.

- When not in use, keep the device out of reach of children.
- Thoroughly inspect the area to be trimmed to avoid any obstacles and remove foreign objects that may be thrown by the trimmer. Otherwise, it could cause an accident and reduce the tool's lifespan.

**⚠ CAUTION** • The area to be trimmed must be well-lit.

**⚠ CAUTION** • Ensure that the trimmer is in optimal condition with the cutting thread guard properly in place. Check that the ventilation slots are free from debris. Do not use the trimmer if the guard is damaged or if it is missing parts.

**⚠ WARNING** • Use only original nylon thread, and under no circumstances replace it with metal thread.

- For best results, it is recommended to use only original replacement threads such as: TRUPER HTA-80B, HIDE-80P, HTA-80, and HDU-15-80.
- Remember that this tool is designed for cutting grass as indicated in this manual. Under no circumstances should it be used for any other purpose.

**⚠ WARNING** • To avoid electric shocks, avoid working in humid environments, during rain, and/or cutting grass with dew.

### While operating the tool

**⚠ CAUTION** • Do not use the trimmer near other people, children, or animals.

**⚠ WARNING** • Never allow the cutting head to exceed 30 cm in height and do not direct it towards people or animals.

**⚠ WARNING** • Use the trimmer to cut only at ground level; do not use it to cut vegetation on rocks or walls.

**⚠ CAUTION** • Do not walk on gravel surfaces while the trimmer is running; the cutting thread can throw gravel fragments at the operator or others, causing injuries.

**⚠ WARNING** • Do not bring hands or feet close to the cutting head while the trimmer is running.

**⚠ DANGER** • If working near traffic lanes, suspend cutting until no vehicles are in sight. Foreign particles thrown by the trimmer towards moving vehicles can cause a serious accident.

### After operating the tool

**⚠ WARNING** • The cutting elements continue to rotate after the engine is turned off.

- Do not attempt to stop the rotating movement of the cutting thread in any other way than releasing the switch. Wait for the reel to stop on its own after turning off the trimmer; this will take a few seconds.

## General warnings for the battery

# TRUPER PRO

- Do not disassemble, open, or shred the cells or the battery.
- Do not short-circuit the battery. Do not store batteries carelessly in a box or drawer where they can short-circuit each other or be short-circuited by conductive materials. When the battery is not in use, keep it away from other metal objects such as clips, coins, keys, nails, screws, or other small metal objects that can create a connection from one terminal to another. Short-circuiting the battery terminals can cause burns or a fire.
- Do not expose the battery to heat or fire. Avoid storing it under direct sunlight.
- Do not subject the battery to mechanical shocks.
- In case of battery leakage, do not allow the liquid to meet the skin or eyes. If contact occurs, thoroughly wash the affected area with water and seek medical advice.
- Keep the battery clean and dry.
- Clean the battery terminals with a clean, dry cloth if they become dirty.
- The battery must be charged before use. Always refer to this instruction manual and use the correct charging procedure.
- Do not keep the battery charging when not in use.
- After prolonged storage periods, it may be necessary to charge and discharge the battery several times to achieve maximum performance.
- Recharge only with the charger specified by TRUPER. Do not use any other charger not specifically provided for use with the equipment.
- Do not use any battery that is not designed for use with the equipment.
- Keep the battery out of reach of children.
- Keep the original product manual for future reference.
- Remove the battery from the equipment when not in use.
- Dispose of properly.
- Do not mix cells from different manufacturers, capacities, sizes, or types within a device.
- Keep the battery away from microwaves and high pressure.

**⚠ WARNING** Do not use non-rechargeable batteries.

## General warnings for the battery charger

**⚠ WARNING** Read all safety warnings and instructions. Failure to follow warnings and instructions may result in electric shocks, fires, and/or serious injuries. **Keep all warnings and instructions for future reference.**

- This device is not intended for use by individuals (including children) with reduced physical, sensory, or mental capabilities, or lack of experience and knowledge, unless they have been provided with supervision or training on the use of the device by a person responsible for their safety. Children should be supervised to ensure they do not play with the device.
- If the charger cable is damaged, it must be replaced by the manufacturer, their service agent, or equally qualified persons to avoid hazards.

### Additional safety instructions for your battery charger

- Read the instructions before charging the batteries.
- Do not charge a leaking battery.
- Do not use chargers for tasks other than those for which they are designed.
- Before charging, ensure that your charger matches the local 127 V power source.
- For indoor use only or do not expose to rain.
- The charging device must be protected from moisture.
- Do not use the charging device outdoors.
- Do not short-circuit the battery or charger contacts.
- Respect the polarity "+/-" when charging.
- Do not open the unit and keep it out of the reach of children.
- Do not charge batteries from other manufacturers or inappropriate models.
- Ensure that the connection between the battery charger and the battery is correctly positioned and not obstructed by foreign objects.
- Keep the battery charger spaces free from foreign objects and protect them from dirt and moisture. Store in a dry and frost-free place.
- Ensure that the battery charger is in a well-ventilated area and away from flammable materials. Batteries can heat up during charging. Do not overcharge them. Ensure that batteries and chargers are not left unattended during charging.
- Do not recharge non-rechargeable batteries as they can overheat and decompose.
- Longer lifespan and better performance can be achieved if batteries are charged when the ambient temperature is between 64.4 °F and 75.2 °F. Do not charge batteries at ambient temperatures below 32 °F or above 104 °F. This is important to avoid serious damage.
- Charge only the battery pack of the same model provided and recommended by TRUPER.

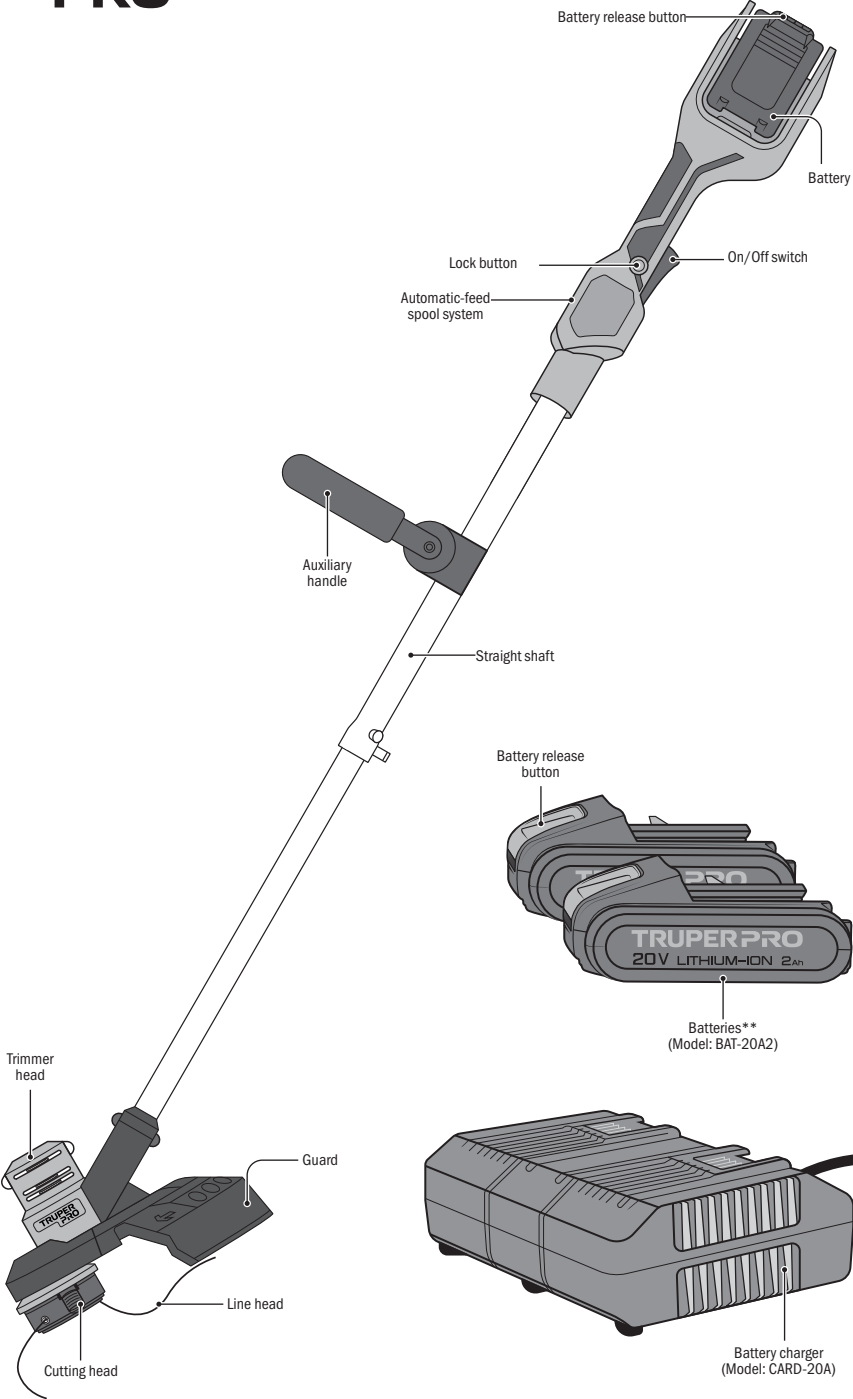

\*\*Only DESI-40A model includes batteries and charger.



## Guard

**⚠ CAUTION** • Operating your equipment without the guard increases the risk of accidents and can cause damage to the machine.

**⚠ CAUTION** • Turn off and remove the batteries from the trimmer before mounting or dismounting the guard.

- Mount the safety guard onto the trimmer head. Align the guard so that it slides into the slots located on the trimmer head.
- Secure the guard to the trimmer head with the included screw.

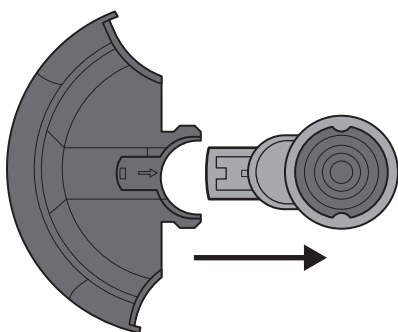

## Assembly of the upper shaft and lower shaft

Connect the upper shaft to the lower shaft. Align and insert the shaft locking tab (A) into the hole (B) on the upper shaft. When the lower shaft is in place, the shaft locking tab will protrude from the hole.

Pull the lower shaft and upper shaft in opposite directions to check if the main handle is assembled correctly.

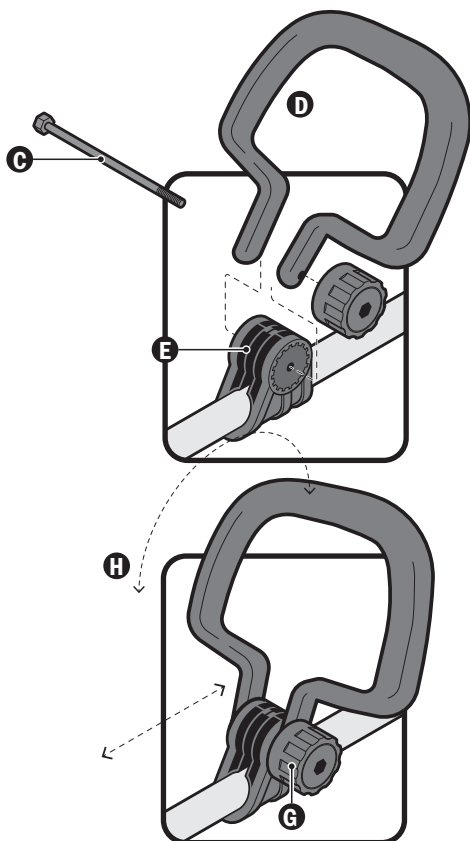
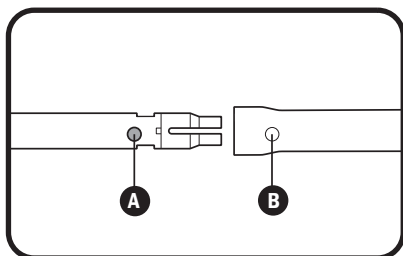

## Auxiliary handle adjustment

- Place the auxiliary handle (D) onto the base (E).
- Insert screw (C) into the hole on the handle (D) and the base (E), securing the assembly by screwing in knob (G).
- The angle and height of the auxiliary handle (H) can be adjusted.
- Loosen knob (G) to position the handle as desired.
- Tighten the knob to lock the handle in place.

### Trimmer line head

- With the trimmer without the batteries, remove the reel retaining cap **(B)** by pressing its side tabs inward and pulling the cap upward.
- Remove the empty reel, ensuring it is clean and free of damaged or worn parts.
- Cut two pieces of trimmer line, each 4 meters long.
- Take one end of the line and thread it through the hole in the reel, then wind it in the direction indicated by the arrow marked on the reel. Do not overwind the line; after winding, there should be a minimum distance of 15 cm between the edge of the reel and the wound line.
- Repeat the same operation for the second cutting line.
- Use the upper notches of the reel to hold the line in place.
- Insert each end of the line through the hole in the spool holder of the cutting head.
- Applying a little tension to the line, assemble the reel into the spool holder ensuring that the line exits from the reel's holding notch.
- Place the reel cap and press down. Press the reel cover against the cutting head until you hear a click.

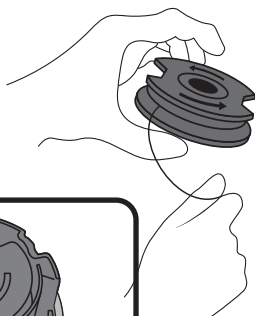
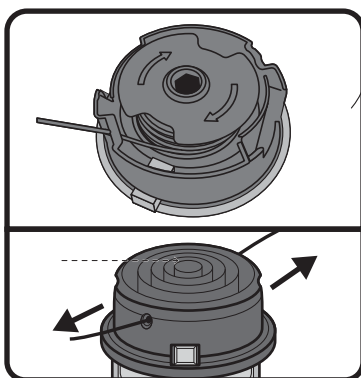
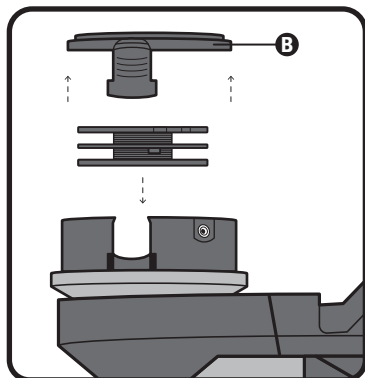

## Start up

### Ignition

- To turn on, first press the lock button **(1)** and then the power on/off switch **(2)**.
- To turn off, release the power on/off switch.

**CAUTION** • The tool will not turn on unless the lock lever and the power on/off button are pressed at the same time.

- To turn off the tool, release the switch trigger.

**CAUTION** • Cutting parts will continue to move for a while after the tool is turned off. Wait until they come to a complete stop. Do not attempt to stop moving cutting parts; there may be a risk of injury!

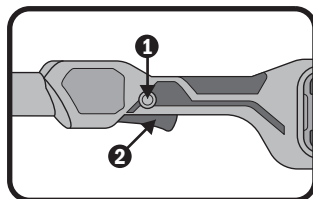

## Battery use considerations

- Batteries come DISCHARGED from the factory. They will need to be charged for approximately 75 minutes before use.
- The normal charging temperature is from 32 °F to 113 °F. Charging is automatically suspended outside this range until it reaches the correct temperature. The normal discharge/operating temperature is from 32 °F to 167 °F. If 167 °F is exceeded, the electronic control shuts off power to the tool

until the temperature returns to the optimal temperature range.

- Between each charge, give the charger a 15-minute rest. In warm environments or after extended use, the battery may become too hot to be recharged. Allow the battery to cool down before attempting to recharge it.

## Charging the battery

1. Plug the charger plug into a 127 V~ outlet (The green light on the charge indicator will turn on).
2. Insert the battery into the charger by sliding it. The level indicator on the battery will light up in a blinking red-orange-green sequence.
3. When the battery is fully charged, the green light will turn back on, and the red one will turn off.
4. Disconnect the charger from the power once the charging is completed.

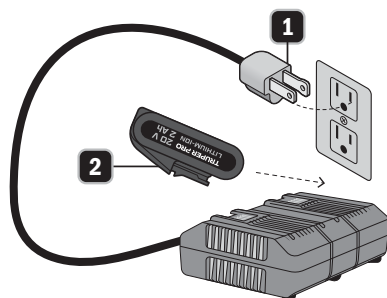

### BATTERY FAILURES

A solid red LED indicates a defective battery, while a flashing red LED indicates overheating; wait for the battery's temperature to be within the appropriate range before attempting to charge.

## Operation

**CAUTION** • Remember that as the operator of the trimmer, you are responsible for your safety as well as those near the work area. Follow all safety rules before, during, and after operating the tool.

- Maintain a balanced posture with both feet firmly planted on the ground.
- Hold the trimmer firmly in front of you with your right hand on the handle at hip height and your left hand on the auxiliary handle so that the tool is aligned with your body and pointing the cutting head downwards, away from your feet.

**DANGER** • Do not turn on or operate the trimmer in any other position.

- Start the trimmer and make cuts from left to right by rotating your waist while maintaining the position of the tool.

**NOTICE** • The trimmer is equipped with a self-feeding head. Striking the head to advance the cutting line will void the trimmer's warranty.

- As grass cutting is performed, the cutting line will wear down and eventually detach. To release more line from the spool while the trimmer is operating, press the automatic line feed button. The cutting line extends approximately 6.5 mm (1/4") each time you press the switch until the cutting line reaches the length of the guard blade.

- When cutting tall weeds or grass, do so gradually; do not attempt to cut them all at once from the base, as debris can jam the cutting head or cause you to lose control of the trimmer.

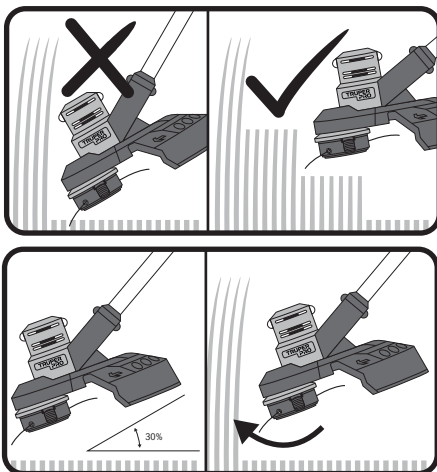
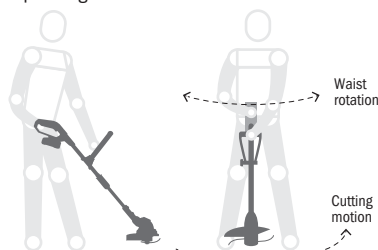

**⚠ CAUTION** Before cleaning and maintenance, always turn off the machine and remove the battery pack from the machine.

## Cleaning and care

- Cleaning the trimmer after each use will keep it in optimal condition and prolong its lifespan.
- For cleaning, use a damp cloth with hot water and a soft brush.

## Service

- Any repairs or maintenance should be carried out only at a TRUPER Authorized Service Center.

## Environment

**⚠ WARNING** • Tool waste material such as packaging, damaged parts, or the tool itself after its useful life should not be handled as regular trash. They should be taken to a recycling center for proper treatment, following all environmental regulations.

# Maintenance

## Storage

- Clean the tool before storing to prevent rusting.
- Store the trimmer in a dry and temperate place, away from direct sunlight (preferably in a dark place) and out of reach of children.
- Avoid storing the trimmer in plastic bags, as the generated moisture could damage it.
- Avoid storing the trimmer with the guard resting on the floor, as it could deform. The trimmer should be stored hanging from the auxiliary handle so that the guard does not touch the floor.

# Accessories and replacements

	103637	REP-DESI-40A	String Trimmer Head
---	--------	--------------	---------------------

# Troubleshooting

## Problem

## Cause

## Corrective action

- The brush cutter does not work.

- Battery drained.
- Battery too hot/cold.
- Broken motor.
- Internal machine wiring damaged.

- Recharge the battery. Refer to "Charging Procedure".
- Allow it to cool/heat up.
- Take the unit to the nearest TRUPER service center.
- Take the unit to the nearest TRUPER service center.

- The brush cutter works intermittently.

- Broken motor.
- Incomplete battery charge.
- Faulty on/off switch.

- Contact a TRUPER service center.
- Recharge the battery.
- Contact a TRUPER service center.

- Excessive vibrations/noise.

- Defective machine.
- Improperly wound reel.

- Contact a TRUPER service center.
- Rewind the trimmer line.

- Battery runtime too short.

- Battery unused for an extended period or only charged for short periods.
- Excessively tall grass.
- Faulty battery.

- Fully charge the battery. Refer to "Charging the Battery".
- Cut in stages.
- Replace the battery.

- The machine does not cut.

- Broken trimmer line.
- Incomplete battery charge.
- Broken motor (running at very low speed).
- Grass tangled around the cutting head.

- Replace the trimmer line.
- Recharge the battery. Refer to "Charging Procedure".
- Contact a service agent.
- Remove the tangled grass.

In the event of any problem contacting a TRUPER Authorized Service Center, please see our webpage [WWW.TRUPER.COM](http://WWW.TRUPER.COM) to get an updated list, or call our toll-free numbers 800 690-6990 or 800 018-7873 to get information about the nearest Service Center.

AGUASCALIENTES	<b>DE TODO PARA LA CONSTRUCCIÓN</b> GRAL. BARRAGÁN #1201, COL. GREMIAL, C.P. 20030, AGUASCALIENTES, AGS. TEL.: 449 994 0537
BAJA CALIFORNIA	<b>SUCURSAL TIJUANA</b> AV. LA ENCANTADA, LOTE #5, PARQUE INDUSTRIAL EL FLORIDO II, C.P. 22244, TIJUANA, B.C. TEL.: 664 969 5100
BAJA CALIFORNIA SUR	<b>FIX FERRETERÍAS</b> FELIPE ÁNGELES ESQ. RUIZ CORTÍNEZ S/N, COL. PUEBLO NUEVO, C.P. 23670, CD. CONSTITUCIÓN, B.C.S. TEL.: 613 132 1115
CAMPECHE	<b>TORNILLERÍA Y FERRETERÍA AAA</b> AV. ÁLVARO OBREGÓN #324, COL. ESPERANZA C.P. 24080 CAMPECHE, CAMP. TEL.: 981 815 2808
CHIAPAS	<b>FIX FERRETERÍAS</b> AV. CENTRAL SUR #27, COL. CENTRO, C.P. 30700, TAPACHULA, CHIS. TEL.: 962 118 4083
CHIHUAHUA	<b>SUCURSAL CHIHUAHUA</b> AV. SILVESTRE TERRAZAS #128-11, PARQUE INDUSTRIAL BAFAR, CARRETERA MÉXICO CUAUHTÉMOC, C.P. 31415, CHIHUAHUA, CHIH. TEL. 614 434 0052
CIUDAD DE MÉXICO	<b>FIX FERRETERÍAS</b> EL MONSTRUO DE CORREGIDORA, CORREGIDORA # 35, COL. CENTRO, C.P. 06060, CUAUHTÉMOC, CDMX. TEL: 55 5522 5031 / 5522 4861
COAHUILA	<b>SUCURSAL TORREÓN</b> CALLE METAL MECÁNICA #280, PARQUE INDUSTRIAL ORIENTE, C.P. 27278, TORREÓN, COAH. TEL.: 871 209 68 23
COLIMA	<b>BOMBAS Y MOTORES BYMTESA DE MANZANILLO</b> BLVD. MIGUEL DE LA MADRID #190, COL. 16 DE SEPTIEMBRE, C.P. 28239, MANZANILLO, COL. TEL.: 314 332 1986 / 332 8013
DURANGO	<b>TORNILLOS ÁGUILA, S.A. DE C.V.</b> MAZURIO #200, COL. LUIS ECHEVERRÍA, DURANGO, DGO. TEL.: 618 817 1946 / 618 818 2844
ESTADO DE MÉXICO	<b>SUCURSAL CENTRO JILOTEPEC</b> PARQUE INDUSTRIAL # 1, COL. PARQUE INDUSTRIAL JILOTEPEC, JILOTEPEC, EDO. DE MÉX. C.P. 54257 TEL: 761 782 9101 EXT. 5728 Y 5102
GUANAJUATO	<b>CÍA. FERRETERA NUEVO MUNDO S.A. DE C.V.</b> AV. MÉXICO - JAPÓN #225, CD. INDUSTRIAL, C.P. 38010, CELAYA, GTO. TEL.: 461 617 7578 / 79 / 80 / 88
GUERRERO	<b>CENTRO DE SERVICIO ECLIPSE</b> CALLE PRINCIPAL MZ.1 LT. 1, COL. SANTA FE, C.P. 39010, CHILPANCINGO, GRO. TEL.: 747 478 5793
HIDALGO	<b>FERREPRECIOS S.A. DE C.V.</b> LIBERTAD ORIENTE #304 LOCAL 30, INTERIOR DE PASAJE ROBLED, COL. CENTRO, C.P. 43600, TULANCINGO, HGO. TEL.: 775 753 6615 / 775 753 6616
JALISCO	<b>SUCURSAL GUADALAJARA</b> AV. ADOLFO B. HORN # 6800, COL: SANTA CRUZ DEL VALLE, C.P.: 45655, TLAJOMULCO DE ZUÑIGA, JAL. TEL.: 33 3606 5285 AL 90
MICHOACÁN	<b>FIX FERRETERÍAS</b> AV. PASEO DE LA REPÚBLICA #3140-A, COL. EX-HACIENDA DE LA HUERTA, C.P. 58050, MORELIA, MICH. TEL.: 443 334 6858

MORELOS	<b>FIX FERRETERÍAS</b> CAPITÁN ANZURES #95, ESQ. JOSÉ PERDIZ, COL. CENTRO, C.P. 62740, CUAUTLA, MOR. TEL.: 735 352 8931
NAYARIT	<b>HERRAMIENTAS DE TEPIC</b> MAZATLÁN #117, COL. CENTRO, C.P. 63000, TEPIC, NAY. TEL.: 311 258 0540
NUEVO LEÓN	<b>SUCURSAL MONTERREY</b> CARRETERA LAREDO #300, 1B MONTERREY PARKS, COLONIA PUERTA DE ANÁHUAC, C.P. 66052, ESCOBEDO, NUEVO LEÓN, TEL.: 81 8352 8791 / 81 8352 8790
OAXACA	<b>FIX FERRETERÍAS</b> AV. 20 DE NOVIEMBRE #910, COL. CENTRO, C.P. 68300, TUXTEPEC, OAX. TEL.: 287 106 3092
PUEBLA	<b>SUCURSAL PUEBLA</b> AV. PERIFÉRICO #2-A, SAN LORENZO ALMECATLA, C.P. 72710, CUAUTLACINGO, PUE. TEL.: 222 282 8282 / 84 / 85 / 86
QUERÉTARO	<b>ARU HERRAMIENTAS S.A. DE C.V.</b> AV. PUERTO DE VERACRUZ #110, COL. RANCHO DE ENMEDIO, C.P. 76842, SAN JUAN DEL RÍO, QRO. TEL.: 427 268 4544
QUINTANA ROO	<b>FIX FERRETERÍAS</b> CARRETERA FEDERAL MZ. 46 LT. 3 LOCAL 2, COL. EJIDAL, C.P. 77710 PLAYA DEL CARMEN, Q.R. TEL.: 984 267 3140
SAN LUIS POTOSÍ	<b>FIX FERRETERÍAS</b> AV. UNIVERSIDAD #1850, COL. EL PASEO, C.P. 78320, SAN LUIS POTOSÍ, S.L.P. TEL.: 444 822 4341
SINALOA	<b>SUCURSAL CULIACÁN</b> AV. JESÚS KUMATE SUR #4301, COL. HACIENDA DE LA MORA, C.P. 80143, CULIACÁN, SIN. TEL.: 667 173 9139 / 173 8400
SONORA	<b>FIX FERRETERÍAS</b> CALLE 5 DE FEBRERO #517, SUR LT. 25 MZ. 10, COL. CENTRO, C.P. 85000, CD. OBREGÓN, SON. TEL.: 644 413 2392
TABASCO	<b>SUCURSAL VILLAHERMOSA</b> CALLE HELIO LOTES 1, 2 Y 3 MZ. #1, COL. INDUSTRIAL, 2A ETAPA, C.P. 86010, VILLAHERMOSA, TAB. TEL.: 993 353 7244
TAMAULIPAS	<b>VM ORINGS Y REFACCIONES</b> CALLE ROSITA #527 ENTRE 20 DE NOVIEMBRE Y GRAL. RODRÍGUEZ, FRACC. REYNOSA, C.P. 88780, REYNOSA, TAMS. TEL.: 899 926 7552
TLAXCALA	<b>SERVICIOS Y HERRAMIENTAS INDUSTRIALES</b> PABLO SIDAR #132, COL. BARRIO DE SAN BARTOLOMÉ, C.P. 90970, SAN PABLO DEL MONTE, TLAX. TEL.: 222 271 7502
VERACRUZ	<b>LA CASA DISTRIBUIDORA TRUPER</b> BLVD. PRIMAVERA, ESQ. HORTENSIA S/N, COL. PRIMAVERA C.P. 93308, POZA RICA, VER. TEL.: 782 823 8100 / 826 8484
YUCATÁN	<b>SUCURSAL MÉRIDA</b> CALLE 33 #600 Y 602, LOCALIDAD ITZINCAB Y MULSAV, MPIO. UMAN, C.P. 97390, MÉRIDA, YUC. TEL.: 999 912 2451

Code	Items	Brand
103243	DESI-40A	<b>TRUPER® PRO</b>
103554	DESI-40AS	

Warranty. Duration: 3 years. Coverage: parts, components and workmanship against manufacturing or operating defects, except if used under conditions other than normal; when it was not operated in accordance with the instructive; was altered or repaired by personnel not authorized by TRUPER®. To make the warranty valid, present the product, stamped policy or invoice or receipt or voucher, in the establishment where you bought it or in Corregidora 35, Centro, Cuauhtémoc, CDMX, 06060, where you can also purchase parts, components, consumables and accessories. It includes the costs of transportation of the product that derive from its fulfillment of its service network. Phone number 800-018-7873. Made in China. Imported by TRUPER, S.A. de C.V. Parque Industrial 1, Parque Industrial Jilotepec, Jilotepec, Edo. de Méx. C.P. 54257, Phone number 761 782 9100.

Stamp of the business. Delivery date:

